

**NOTES FOR INFORMATION:**

**KEY:**

- Land (Title) to be acquired
- New Rights (Easement) to be acquired

Rev	Description	Date	By	Check	Approved
P01	First Draft	10/01/22	LH	**	**

This map is reproduced from Ordnance Survey material with the permission of Ordnance Survey on behalf of the Controller of Her Majesty's Stationery Office. © Crown Copyright. Unauthorised reproduction infringes Crown Copyright and may lead to prosecution or civil proceedings. Oxfordshire County Council, 010023343, 2021



THE OXFORDSHIRE COUNTY COUNCIL  
 (HIGHWAYS INFRASTRUCTURE – A40  
 HIF2 SMART CORRIDOR  
 (HILL FARM TO DUKES CUT))  
 COMPULSORY PURCHASE ORDER 2022

COMPULSORY PURCHASE ORDER  
 SHEET 12 OF 19  
 A40 SMART CORRIDOR – CASSINGTON ROAD  
 JUNCTION AND EYNSHAM ROAD JUNCTION TO  
 EAST OF MARLBOROUGH POOL

The COMMON SEAL of  
 Oxfordshire County Council  
 was herunto affixed in the  
 presence of –



Authorised Officer  
 Dated this day of 2022 Seal No. ....

Drawn	Checked	Approved	Date
LH	**	**	10/01/22

GH Project Number 132861.005	Scale at A1 1:1,000
Drawing Number GH-132861005-CPO-12	Revision P01

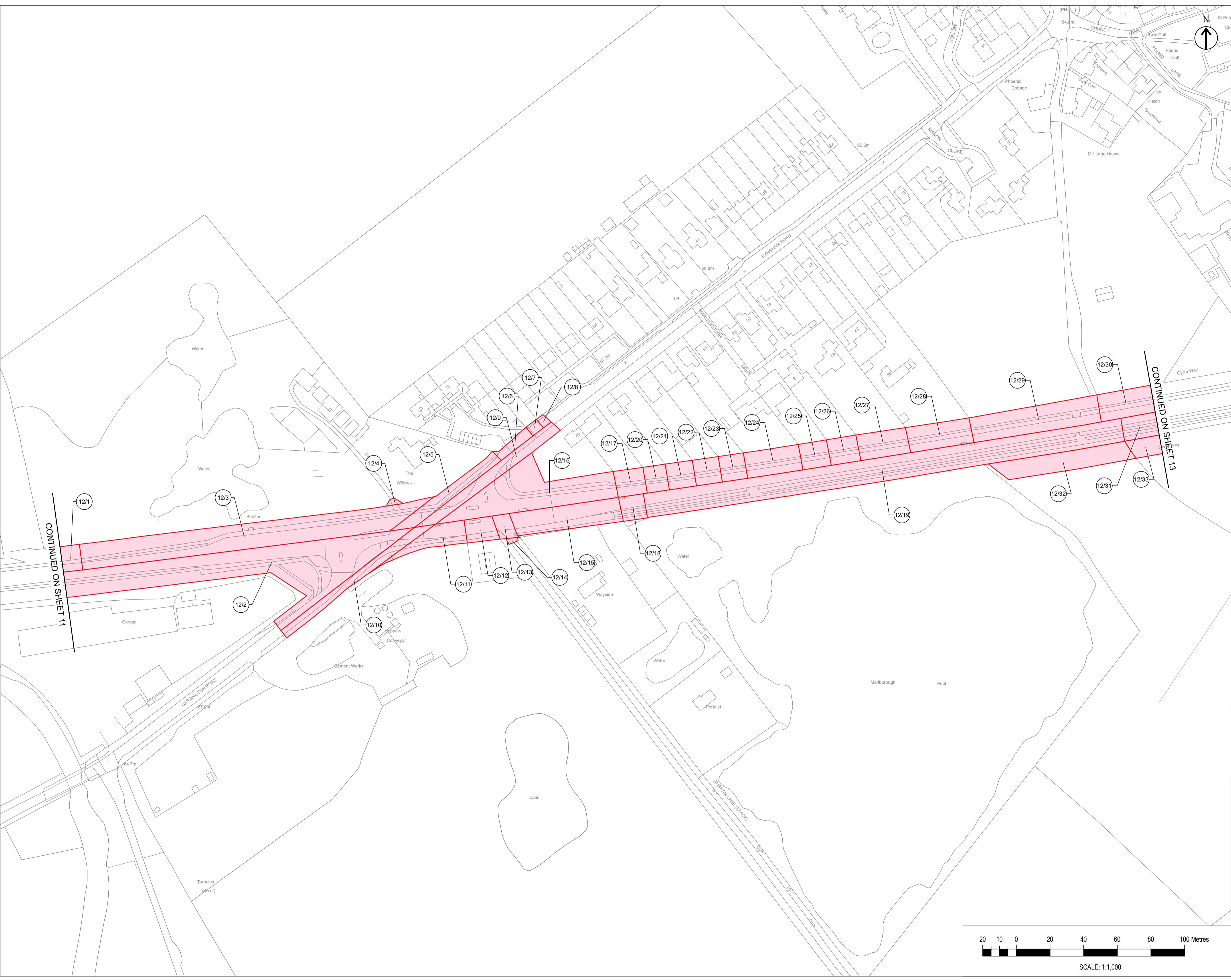
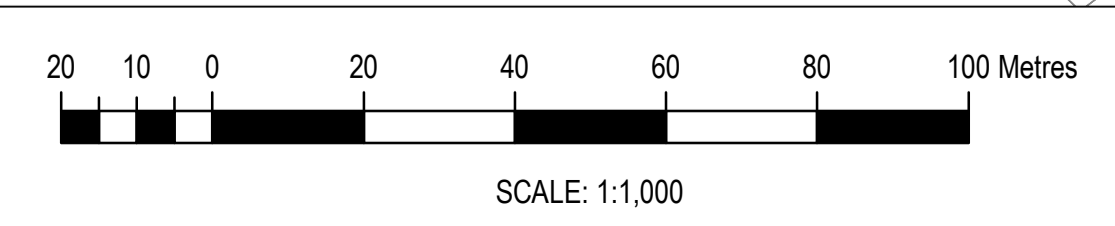

CONTINUED ON SHEET 11

CONTINUED ON SHEET 13